

HOW TO ORDER ADDITIONAL ELECTROSTATIC PADS:

THREE EASY WAYS TO ORDER DISPOSABLE ELECTROSTATIC PADS:

1. Visit our website at www.robomop.net
2. Credit card holders call 24 hours/7 days toll free **phonenumber**
3. Send your name and address along with a check or money order for just «price» plus «price» s&h for a box of 25 electrostatic pads, to:

Distributon Details

WARRANTY:

This RoboMop brand product, as supplied and distributed by Distributon name, and delivered new, in the original carton to the original customer purchaser, is warranted by Distributon name against manufacturing defects in materials and workmanship for the qualifying limited warranty period as follows below in our guarantee:

RoboMop™ 30 DAY GUARANTEE

This product is warranted against any defect in workmanship for a period of 30 days. For more information on RoboMop, please visit us on the web: www.robomop.net

EXCEPT AS EXPRESSLY STATED, Telebrands MAKES NO WARRANTY, EXPRESSED OR IMPLIED. Some states have varying limitations on how long a warranty period may be, so this may not apply to you. IN NO EVENT SHALL Distributon name BE LIABLE FOR ANY SPECIAL INDIRECT, INCIDENTAL OR CONSEQUENTIAL DAMAGES caused by the use, misuse, or handling of this product. Liability for this product is limited to the purchase price of this product.

OPERATOR'S MANUAL

Sweeps Your Floors So You Don't Have To!

THE CLEANING REVOLUTION!

RoboMop®

Workbooks Patented and Patent Pending!

EXCELLENT FOR:

- Wood Floors
- Granite
- Marble
- Ceramic Tile
- Linoleum

INCLUDES:

- RoboMop Sweeper
- Robotic Ball
- Built-in Rechargeable Battery
- Battery Charger
- 5 Electrostatic Pads

Cleans under furniture
Sterily cleans – shuts off automatically when the program is done.

VoltaWeb™ Electrostatic Pads
Disposable pads attract dirt, dust bunnies, and hair like a magnet.

Smart Navigation Technology
Senses walls and objects, automatically changing directions.

Programmable PowerSense™ Ball
Simply set the robotic ball for desired cleaning time!

www.robomop.net



WWW.ROBOMOP.NET

RoboMop

OPERATOR'S MANUAL

RoboMop is the cleaning sensation from Norway and is now available in the Country exclusively from the Company name! RoboMop is designed to sweep your floors for you so you'll have extra time to take care of more important things or just sit back and relax. Simply attach an Electrostatic Pad, set the cleaning time on the Robotic Ball, place it in the Cleaning Frame and watch RoboMop automatically sweep your floors for you—it's that easy! The Electrostatic Pad attracts dirt and hair like a magnet. Then when it's soiled, just remove and toss it in the trash. Using smart sensor technology, it navigates smoothly and silently, cleaning dirty edges under the kitchen counter, around walls and under furniture. The flexible edges won't damage furniture. It's great for all your hard floor surfaces like wood floors, ceramic tile, granite, marble, and linoleum. You'll love your new RoboMop.

THIS SET INCLUDES THE FOLLOWING PARTS:

NOTE:

Read all safety and operating instructions before operating your new RoboMop.

1 AC Battery Charger

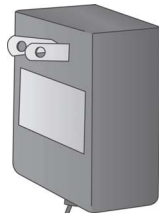

1 Cleaning Frame and 1 Robotic Ball

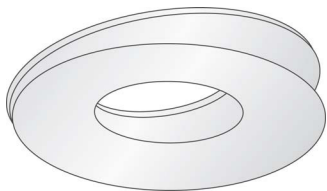

5 Electrostatic Disposable Cloths

FREQUENTLY ASKED QUESTIONS:

- Q.** My RoboMop gets stuck. What should I do?
A. Your RoboMop may occasionally get stuck, especially in rooms that it has not cleaned before. If it does get stuck, RoboMop will try to free itself by turning in different directions. If it cannot free itself, move or block any object that RoboMop gets stuck on or under. Once the problem areas have been amended, pick up your RoboMop and reposition. Your RoboMop might get stuck for several reasons.
1. It is wedged or pinned between or under narrowly spaced objects.
 2. RoboMop bumps into objects and repositions them in such a way that an exit path no longer exists.
- Q.** My RoboMop Cleaning Frame has broken. What shall I do?
A. Please call phonenumber and request a new Cleaning Frame. We shall send you a new Cleaning Frame FREE OF CHARGE for up to one year from purchase. Please pay only «price» to help cover the shipping and handling charges.
- Q.** Are pets and children safe around RoboMop?
A. Children and pets should always be supervised around RoboMop for optimum safety and cleaning performance.
- Q.** Does RoboMop clean corners and along the walls?
A. RoboMop cleans next to walls, most corners and other tough to reach places.
- Q.** Will it go under kickboards, beds, and furniture?
A. RoboMop has been designed to fit under the kickboards in your kitchen. If your bed or furniture is more than 4" off the floor, your RoboMop will happily clean underneath.
- Q.** How long does it take to recharge the RoboMop?
A. Approximately 3-5 hours.
- Q:** Will RoboMop clean all floor surfaces?
A: RoboMop cleans hardwood, linoleum, tile, ceramic tile, marble, granite and other hard floor surfaces.

FOR OPTIMAL CLEANING PERFORMANCE:

For optimal cleaning performance, clear your floor of objects just as you would before using a regular vacuum cleaner. Do not leave the following items on the floor: clothing, loose papers, pull cords for blinds or curtains, power cords, or any fragile items. RoboMop contacts walls, furniture and other objects as it cleans, so please remove any items that may be pushed and knocked over by light contact from RoboMop. If your room does not have a door, or there is access to a stairway where RoboMop can fall down the stairs, simply block off the area with either a chair, plant, gate or other object.

HELPFUL ROOM CLEANING TIPS:

AVOID GETTING STUCK

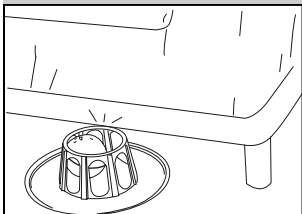

RoboMop may come upon a piece of furniture like this couch, which RoboMop can get wedged up against and get stuck. If RoboMop can't get out, just pull it out and set it back to work again. Or you can put a small object in front of it, so RoboMop can't get stuck underneath.

AVOID MESSY SPILLS

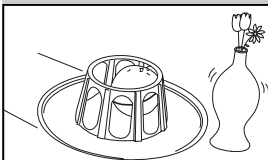

RoboMop may bump into small items that can spill and make a mess. To make sure RoboMop can clean the whole floor; pick up any small objects, just as you do before you vacuum.

DON'T GET TRAPPED

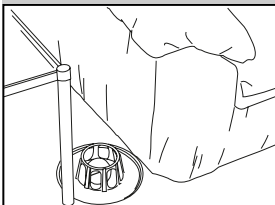

RoboMop can get trapped between or behind your furniture because the entrance to an area is barely big enough for RoboMop to fit through. Placing a chair or plant in front of the piece of furniture, can solve the trouble so it won't stop working.

RoboMop

STEP BY STEP GUIDE:

step 1

CHARGE THE ROBOTIC BALL FOR 3-5 HOURS

Before initial use, charge the ball. Insert the plug of the AC Battery Charger into the Charger Port jack of the Robotic Ball. **(See Figure A)** Plug the AC Battery Charger into a voltage tape AC Outlet ONLY. **(See Figure B)** The ball will fully charge in about 3-5 hours. Recharge the unit only when it is completely discharged.

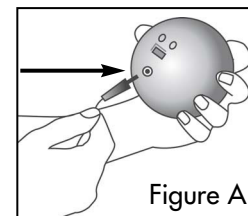

Figure A

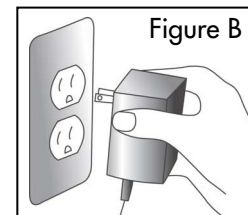

Figure B

step 2

ATTACH ONE ELECTROSTATIC PAD

Attach one disposable electrostatic pad to the underside of the Cleaning Frame and secure by pushing the pad down onto the black velcro tabs around the perimeter of the Cleaning Frame. **(See Figure C)**

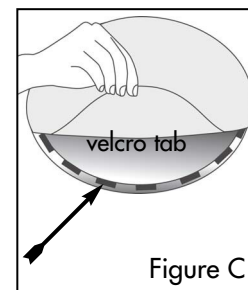

Figure C

step 3

PLACE THE CLEANING FRAME IN THE CENTER OF THE ROOM

Clear the room. Place the Cleaning Frame in the center of the room. **(See Figure D)** For preparation hints for clearing the room, see page 6 of this operator's manual for our "For Optimal Cleaning Performance" tips."

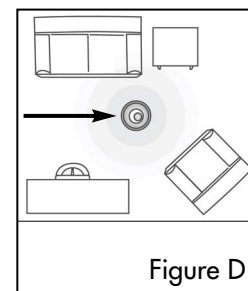

Figure D

STEP BY STEP GUIDE:

step 4

SELECT CLEANING TIME

Press the Green ON/TIME button located on your RoboMop under the LCD screen on the left. (See Figure E) The LCD display screen will show the amount of time the RoboMop will clean your floor. To choose 1 hour and 30 minutes, press the ON/TIME button once. To choose 1 hour, press the ON/TIME button twice. To choose 30 minutes, press the ON/TIME button three times. Once you have chosen the time, the ON/TIME button on the LCD screen will flash 6X before turning on automatically, allowing you sufficient time to place the ball in the Cleaning Frame.

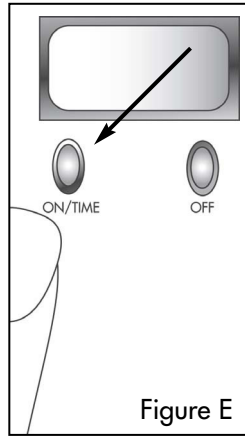

step 5

INSERT THE ROBOTIC BALL IN THE CLEANING FRAME

Place the RoboMop ball into the center of the Cleaning Frame. Within 6 seconds, the RoboMop will turn itself on automatically. (See Figure F)

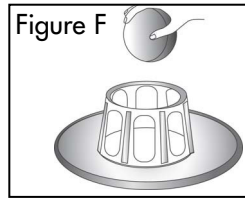

step 6

AUTOMATIC SHUT OFF

RoboMop will automatically shut off when the program is complete, based on the time you set it to. To stop the RoboMop at any time, simply press the Red OFF button. When RoboMop is finished cleaning, remove it from the floor to avoid tripping or falling over it. (See Figure G)

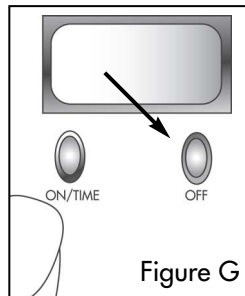

step 7

DISPOSAL OF PADS

Dispose soiled pads in the trash. (See Figure H) Do not dispose soiled pads in the toilet.

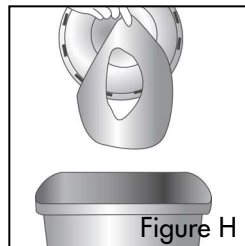

WARNINGS:

- Read all safety and operating instructions before operating RoboMop.
- Retain the safety and operating instructions for future reference.
- Always be careful when using your RoboMop. To reduce the risk of injury or damage, keep these safety precautions in mind when setting up, using and maintaining your equipment.
- RoboMop must not be used for any other purpose other than its intended use.
- Store out of reach of children.
- Do not bend the Cleaning Frame.
- Charge the robotic ball only when it is completely discharged.
- This is an indoor device only.
- Do not use RoboMop on wet or damp surfaces or where immersion in water is a possibility.
- Operate your RoboMop only from the type of power source indicated in this manual. If you are not sure of the type of power supplied to your home, consult your local power company.
- Plug the AC Battery Charger into a voltage tape AC OUTLET ONLY. Product may not be used with any type of power converter. Any such use will immediately void the Warranty.
- Use only the AC Battery Charger supplied by the manufacturer to charge and recharge this device.
- Charge indoors only.
- Never handle the AC Battery Charger with wet hands.
- Always remove AC Battery Charger from wall and disconnect RoboMop after charging.
- RoboMop is not for use on carpets.
- RoboMop is designed to clean one room at a time. Confine RoboMop to the room you want cleaned by closing all doors.
- Observe RoboMop the first time it cleans a room to confirm it does not get wedged under or stuck on top of uneven surfaces.
- The Cleaning Frame should not be washed. Clean softly with a duster or clean with a dry soft cloth.
- Use the specifically designed electrostatic pads on dry floors only.
- Protect the Cleaning Frame from bending, warping or folding.
- When RoboMop is finished cleaning, remove RoboMop from the floor to avoid tripping over it.